



# Emergency Planning & Response



**UNIVERSITY OF ILLINOIS** AT URBANA-CHAMPAIGN

# We Are

- **Division of Public Safety**
  - We provide full-service community-based policing for the University community
- **Emergency Management**
  - We provide the planning, training, exercising, for any potential incident that could occur on campus



# Run > Hide > Fight

- **Run** — Leaving the area quickly is the best option if it is safe to do so
- **Hide** — When you can't or don't want to run, take shelter indoors
- **Fight** — As a last resort, you may need to fight to increase your chances of survival



# Building Emergency Action Plan

- Run > Hide > Fight
- Communications
- Accountability
- Floor Plans



# Building Emergency Action Plan

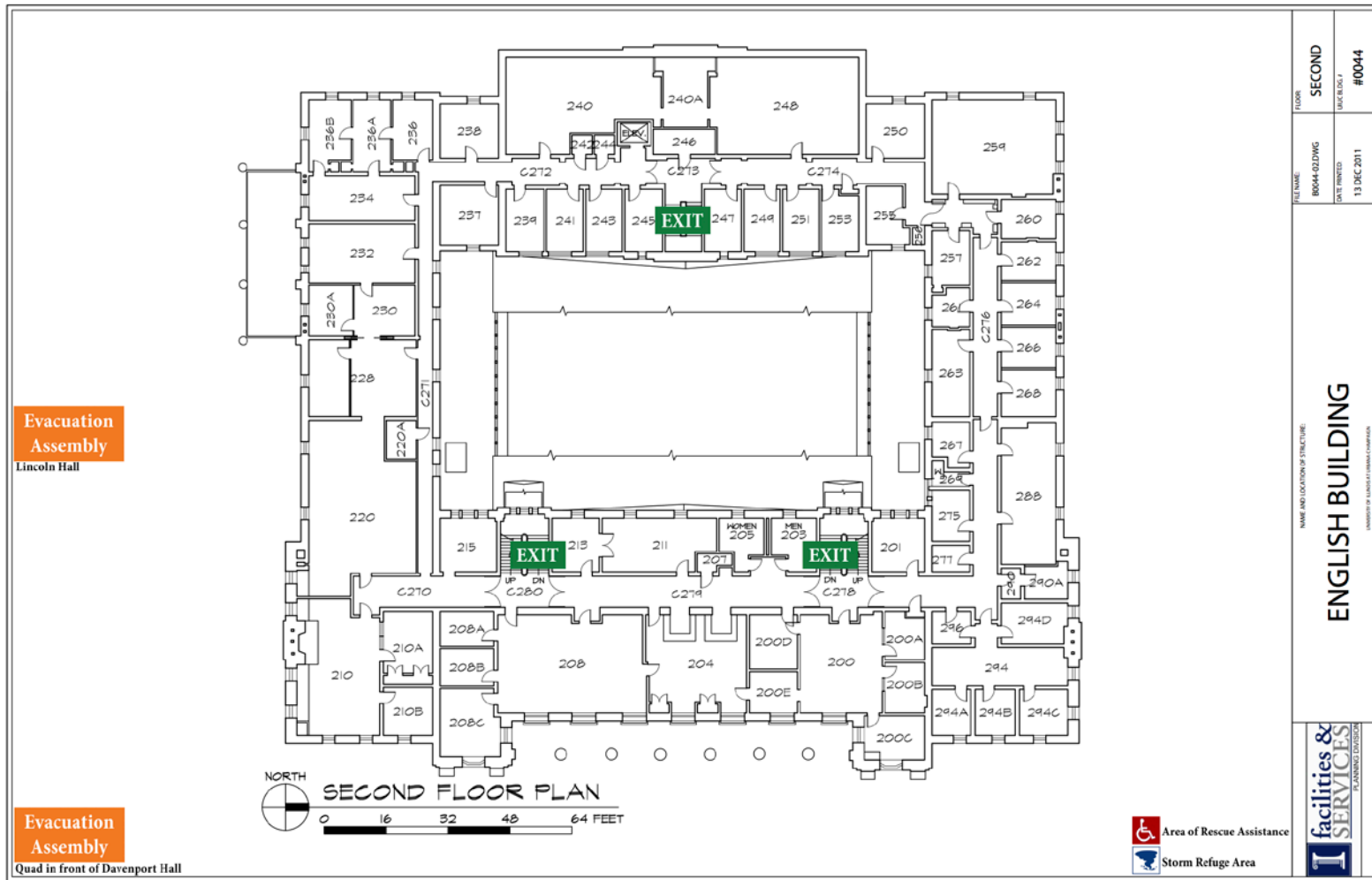

# Whom to Call

- Immediate Threat to Safety:

**9-1-1**

- Non-Emergency:
  - METCAD: 333-8911
  - UIPD: 333-1216
- Student Counseling: 333-3704
- Emergency Dean: 333-0050



# Resources

- University of Illinois Police Department:  
<http://police.illinois.edu/>
- Counseling Center:  
<http://counselingcenter.illinois.edu/>
- Emergency Dean:  
<http://www.odos.illinois.edu/emergency/>

